

# 双引线双孔法兰衰减器 ( Flanged Attenuators 35W/50W)

## 主要技术指标 (General Specifications)

- 基片 (Substrate) : 氧化铍 (BeO)
- 电阻材料 ( Resistive Material) : 厚膜 (Thick Film)
- 引线 (Tabs) : 镀铜镀银 (Silver Plated Beryllium Copper)
- 盖 (Cover) : 氧化铝 (Al<sub>2</sub>O<sub>3</sub>)
- 阻抗 (Impedance) : 50 Ω
- 法兰(Flange):铜镀镍 (Nickel Plated Copper)

## 产品规格 (Product Reference)

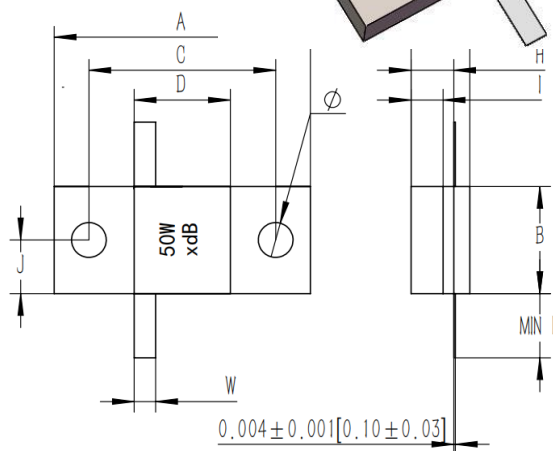
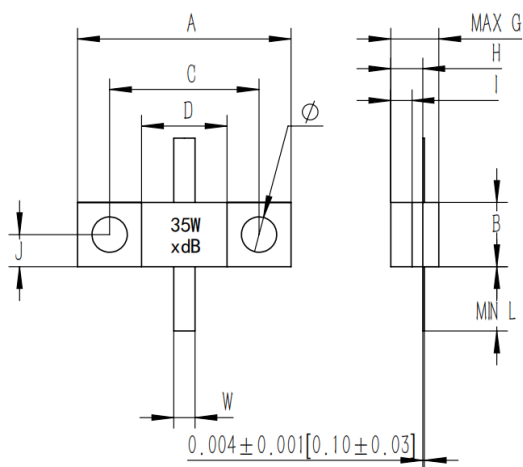
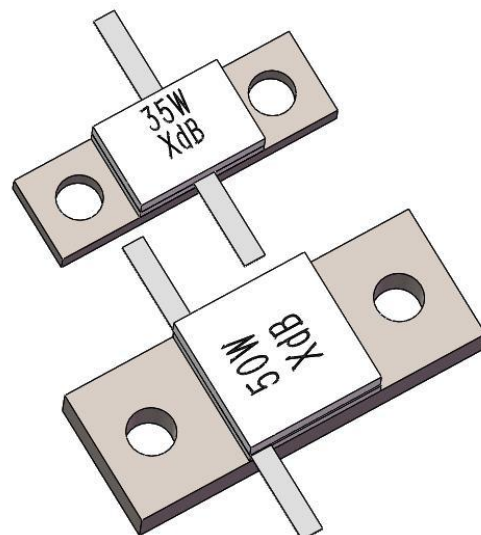

型号 Part Number	外形尺寸 Dimensions										
	A	B	C	D	G	H	I	J	L	W	Φ
RPA200-35W-XdB	0.787	0.236	0.550	0.354	0.160	0.102	0.062	0.115	0.250	0.060	0.130
	[20.00]	[6.00]	[13.97]	[9.00]	[4.06]	[2.57]	[1.57]	[2.92]	[6.35]	[1.52]	[3.30]
RPA250-50W-XdB	0.975	0.375	0.725	0.375	0.220	0.161	0.120	0.188	0.250	0.060	0.125
	[24.77]	[9.53]	[18.42]	[9.53]	[5.59]	[4.09]	[3.05]	[4.76]	[6.35]	[1.52]	[3.18]

尺寸单位为英寸[毫米] (Dimensions are in inches[mm]) ; 公差为: .xxx=±0.010 .XX=±0.015

型号 Part Number	衰减量 Attenuation (dB)	衰减精度 Attenuation Accuracy (dB)			功率 Power (W)	驻波比 VSWR (max)		
		DC-1.0GHz	1.0-2.0GHz	1.0-2.5GHz		DC-1.0GHz	1.0-2.0GHz	1.0-2.5GHz
RPA200-35W-XdB	0-5	±0.3		±0.5	35	1.15:1		1.25:1
	6-9	±0.3		±0.5				
	10-15	±0.3		±0.5				
	16-20	±0.5		±0.5				
	21-30	±1.0		±3.0				
RPA250-50W-XdB	0-5	±0.3		±0.5	50	1.15:1		1.25:1
	6-9	±0.3		±0.5				
	10-15	±0.3		±0.5				
	16-20	±0.5		±0.5				
	21-30	±1.0		±3.0				

### 订货指南 (Ordering Information)

例 (Example) :

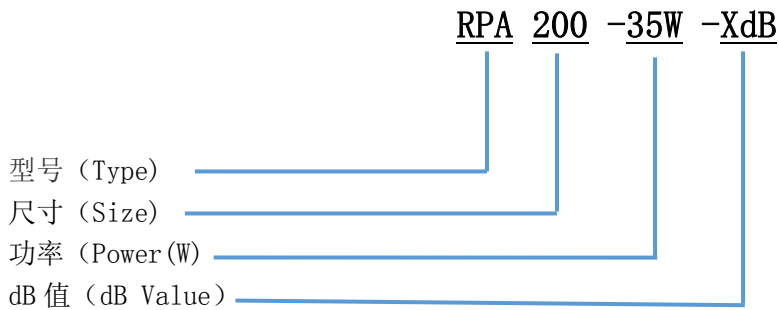

### 降功耗曲线 (Power Derating)

