

双引线单孔法兰衰减器 (Flanged Attenuators 10W/20W/25W)

主要技术指标 (General Specifications)

- 基片 (Substrate) : 氧化铍 (BeO)
- 电阻材料 (Resistive Material) : 厚膜 (Thick Film)
- 引线 (Tabs) : 镀铜镀银 (Silver Plated Beryllium Copper)
- 盖 (Cover) : 氧化铝 (Al₂O₃)
- 阻抗 (Impedance) : 50 Ω
- 法兰(Flange):铜镀镍 (Nickel Plated Copper)

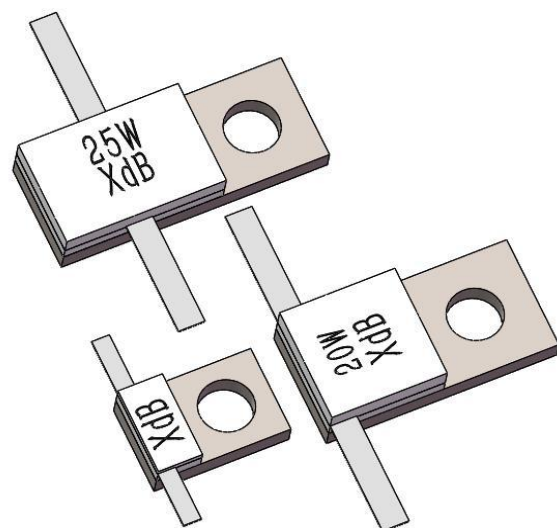

产品规格 (Product Reference)

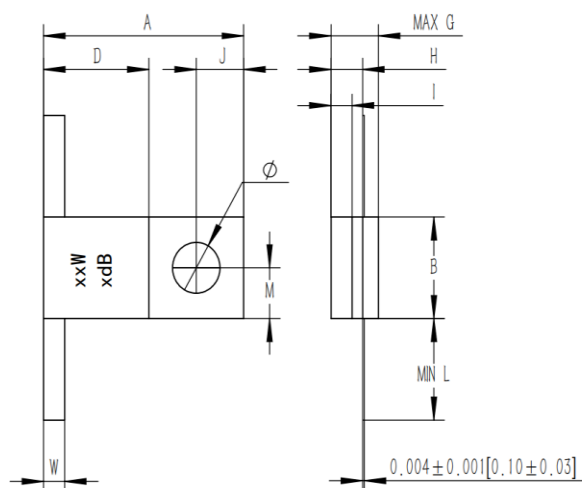

RPA762-10W-XdB
RPA131-20W-XdB

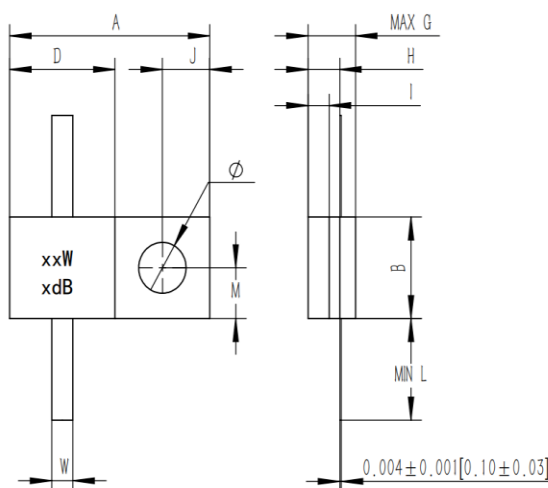

RPA146-25W-XdB

型号 Part Number	外形尺寸 Dimensions										
	A	B	D	G	H	I	J	L	M	W	Φ
RPA762-10W-XdB	0.300 [7.62]	0.200 [5.08]	0.100 [2.54]	0.123 [3.12]	0.102 [2.59]	0.062 [1.57]	0.100 [2.54]	0.125 [3.18]	0.100 [2.54]	0.040 [1.02]	0.116 [2.94]
RPA131-20W-XdB	0.515 [13.08]	0.250 [6.35]	0.250 [6.35]	0.160 [4.06]	0.105 [2.67]	0.062 [1.57]	0.125 [3.18]	0.250 [6.35]	0.125 [3.18]	0.060 [1.52]	0.116 [2.95]
RPA146-25W-XdB	0.575 [14.61]	0.236 [6.00]	0.354 [9.00]	0.160 [4.06]	0.105 [2.67]	0.062 [1.57]	0.125 [3.18]	0.250 [6.35]	0.115 [2.92]	0.060 [1.52]	0.130 [3.30]

尺寸单位为英寸[毫米] (Dimensions are in inches[mm]) ; 公差为: .xxx=±0.010 .XX=±0.015

型号 Part Number	衰减量 Attenuation (dB)	衰减精度 Attenuation Accuracy (dB)				功率 Power (W)	驻波比 VSWR (max)			
		DC-1.0GHz		2.0-4.0GHz			DC-1.0GHz		2.0-4.0GHz	
		1.0-2.5GHz	DC-2.0GHz	1.0-2.5GHz	DC-2.0GHz					
RPA762-10W-XdB	0-10		±0.5	±0.5	10	1.15:1	1.25:1			
	11-20		±1.0	±1.0						
RPA131-20W-XdB	0-5	±0.5	±0.5		20	1.15:1	1.35:1			
	6-9	±0.5	±0.5							
	10-15	±0.5	±1.0							
	16-20	±0.5	±1.0							
	21-30	±1.0	±1.0							
RPA146-25W-XdB	0-5	±0.3	±0.5		25	1.15:1	1.25:1			
	6-9	±0.3	±0.5							
	10-15	±0.3	±0.5							
	16-20	±1.0	±1.0							
	21-30	±1.0	±3.0							

订货指南 (Ordering Information)

例 (Example) :

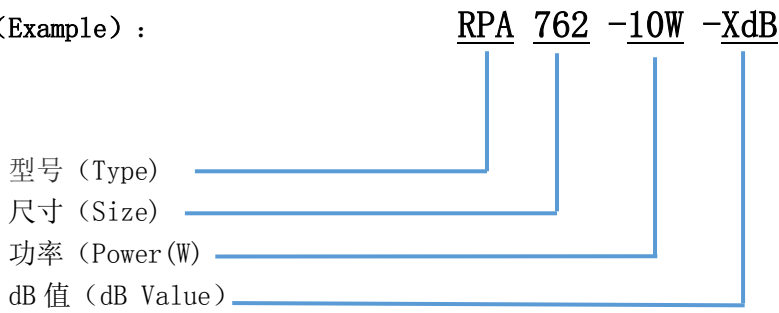

降功耗曲线 (Power Derating)

