

# 同轴用衰减片 (Chip Attenuators 1W/10W/30W/50W)

## 性能参数 (Performance Specifications)

型号 (Part Number): RPCA  
 标称阻值 (Nominal Impedance): 50 Ω  
 基片 (Substrate): alumina, BeO  
 功率 (Power): 1W~50W  
 工作温度 (Operating Temperature): -55°C - +150°C  
 包装 (Packaging): 散装 (Bulk)

## 产品规格 (Product Reference)

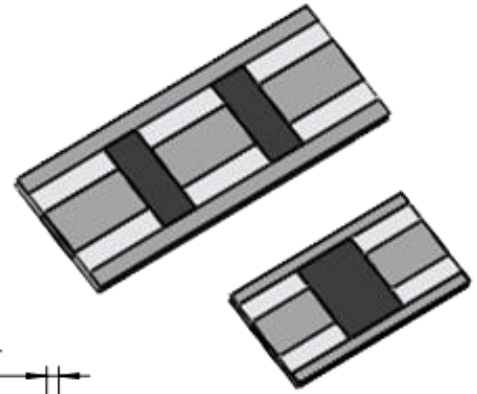
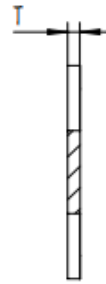
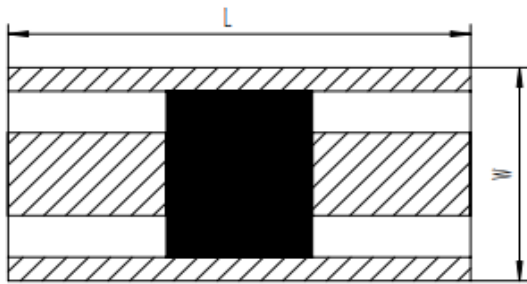

型号 PN	功率 POWER (W)	频率 FREQ.(GHz)	衰减值 ATT. VALUE (dB)	精度 Tolerance(±dB)	电压驻波比 VSWR MAX	尺寸 (mm) Dimension		
						L	W	T
RPCA053050	1	DC-6	1-10	0.50	1.30	5.3	5	0.40
			11-20	0.75	1.30			
			21-30	1.00	1.30			
RPCA1909	10	DC-6	1-10	0.50	1.30	19	9	0.50
			11-20	0.75	1.30			
			21-30	1.00	1.30			
RPCA3211	30	DC-6	1-10	0.50	1.30	32.2	11	0.70
			11-20	0.75	1.30			
			21-30	1.00	1.30			
RPCA2525	50	DC-4	1-10	0.50	1.30	25.5	25.5	3.20
			11-20	0.75	1.30			
			21-30	1.00	1.30			

未注公差处均为±0.25mm (Tolerance is ±0.25mm[0.01 inches] unless noted.)

## 订货指南 (Ordering Information)

型号 (Type)      RPCA1909-10W-XXdB  
 功率 (Power)    10W  
 衰减值 (ATT. Value)    XXdB

## 降功耗曲线 (Power Derating)

