

# 单引线双孔法兰负载 ( Flanged Terminations 100W/150W/250W/400W/500W )

## 主要技术指标 (General Specifications)

- 基片 (Substrate) : 氧化铍 (BeO)
- 电阻材料 ( Resistive Material ) : 厚膜 (Thick Film)
- 引线 (Tabs) : 镀银镀铜 (Silver Plated Beryllium Copper)
- 盖板 (Cover) : 氧化铝 (Al2O3)
- 法兰 (Flange) : 镀镍铜 (Nickel Plated Copper)
- 阻抗 (Impedance) : 50 Ω

## 产品规格 (Product Reference)

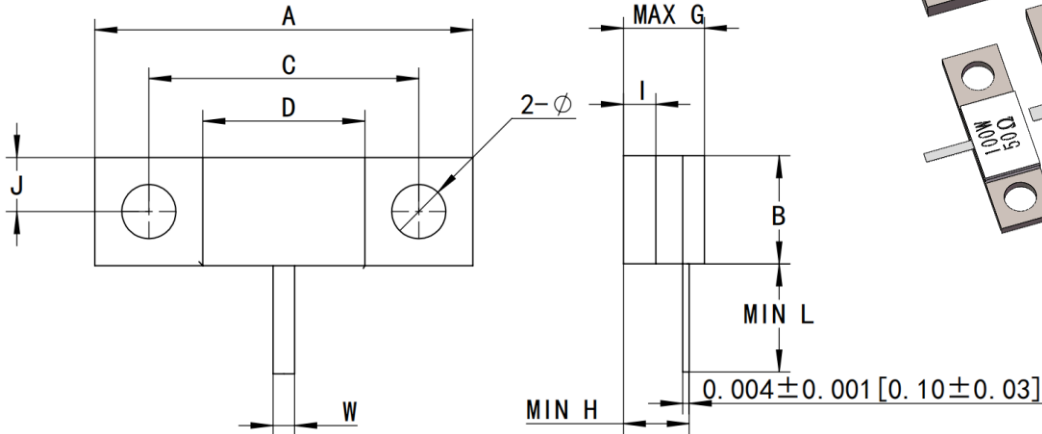
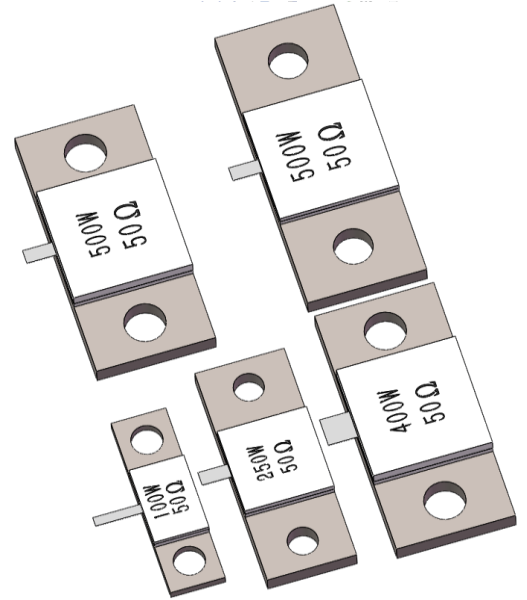

型号 Part Number	功率 Power (W)	频率 Frequency (GHz)	驻波比 VSWR (max)	外形尺寸 Dimensions										
				A	B	C	D	G	H	I	J	L	W	Φ
RPT200-100W/150W-50-5	100/150	DC-4.0GHz	1.25:1	0.787	0.236	0.560	0.354	0.150	0.105	0.062	0.200	0.200	0.040	0.130
		DC-6GHZ	1.3:1	[20.00]	[6.00]	[14.22]	[9.00]	[3.81]	[2.67]	[1.57]	[5.08]	[5.08]	[1.02]	[3.30]
RPT250-250W-50-5	250	DC-3.0GHz	1.25:1	0.975	0.375	0.725	0.375	0.210	0.168	0.125	0.187	0.125	0.060	0.125
				[24.77]	[9.53]	[18.42]	[9.53]	[5.33]	[4.27]	[3.18]	[4.75]	[3.18]	[1.52]	[3.18]
RPT280-400W-50-5	400	DC-1.0GHz	1.35:1	1.100	0.500	0.800	0.500	0.260	0.171	0.125	0.250	0.125	0.120	0.170
				[27.94]	[12.70]	[20.32]	[12.70]	[5.35]	[4.34]	[3.18]	[6.35]	[3.18]	[3.05]	[4.32]
RPT280-500W-50-5	500	DC-2.0GHz	1.25:1	1.100	0.500	0.800	0.500	0.260	0.171	0.125	0.250	0.125	0.060	0.170
				[27.94]	[12.70]	[20.32]	[12.70]	[5.35]	[4.34]	[3.18]	[6.35]	[3.18]	[1.52]	[4.32]
RPT320-500W-50-5	500	DC-2.0GHz	1.25:1	1.250	0.500	0.875	0.500	0.210	0.168	0.125	0.250	0.125	0.060	0.160
				[31.75]	[12.70]	[22.23]	[12.70]	[5.33]	[4.27]	[3.18]	[6.35]	[3.18]	[1.52]	[4.06]

尺寸单位为英寸[毫米] (Dimensions are in inches[mm]) ; 公差为: .xxx $\pm$ 0.010 .XX $\pm$ 0.015

## 订货指南 (Ordering Information)

例 (Example) : **RPT 200 N-250W-50-5 G**

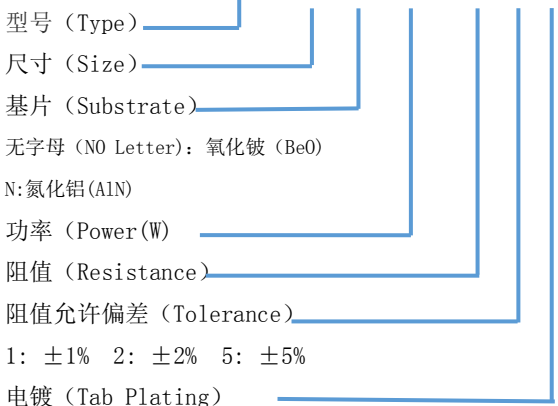

无字母 (No Letter) : 镀银 (Silver Plated Tab) G:镀金 (Gold Plated Tab)

## 降功耗曲线 (Power Derating)

