

QWCA-62-S

WR-62 to SMA

Features:
* Low VSWR

Applications:
* Wireless
* Transmitter
* Laboratory Test
* Radar

Electrical

Frequency: 11.9~18GHz
VSWR: 1.2 max.

Mechanical

RF Connectors: SMA
Interface: WR-62
Flange: FBP140
Material: Aluminium

How To Order

QWCA-62-X-Y

X: Connector type.

Y: End launch: E, Right angle: R.

E - End launch (Outline B)

R - Right angle (Outline A)

Connector naming rules:

S - S Male (Outline A, Outline B)

SF - S Female (Outline A, Outline B)

Examples:

To order a waveguide to coax adapter, WR-62 to SMA female, right angle, specify QWCA-62-SF-R.

Customization is available upon request.

Outline Drawings

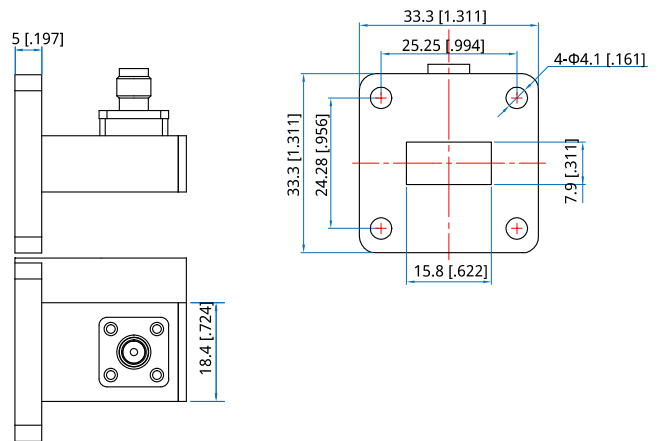

Outline A

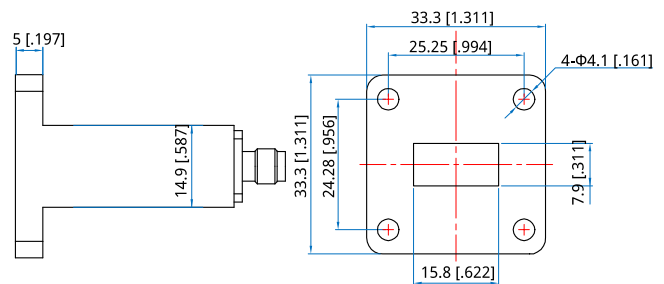

Outline B

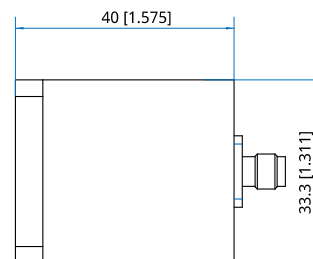

Unit: mm [in]

Tolerance: ±0.2mm [±0.008in]