

# QVLC-2F-1

## DC~50GHz

Features:  
\* Low VSWR

Applications:  
\* Wireless  
\* Radar  
\* Instruments  
\* Electronics

### Electrical

Frequency: DC~50GHz  
VSWR: 1.2 max.  
Impedance: 50Ω

### Mechanical

RF Connector: 2.4mm female  
Outer Conductor: Passivated SU303 stainless steel  
Inner Conductor: Gold plated beryllium copper

### Outline Drawings

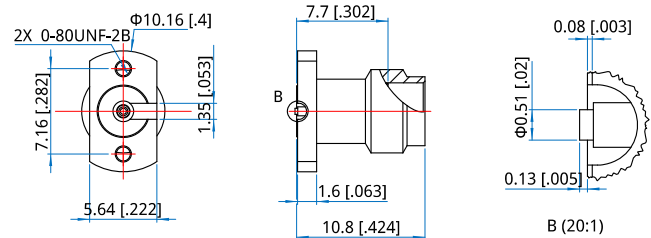

Unit: mm [in]

Tolerance:  $\pm 0.2$ mm [ $\pm 0.008$ in]

### How To Order

**QVLC-2F-1**

Customization is available upon request.